



Rugged design

Low Profile

Does not require a ground plane

The Panorama low profile antenna range has been designed to perform under extreme pressure. The outer housing is designed to withstand high impacts while maintaining functionality.

The antenna does not require a metallic ground plane, and is tuned to operate on a non-metallic ground plane as standard.

A version with GPS is available part number LG390

Technical Drawing

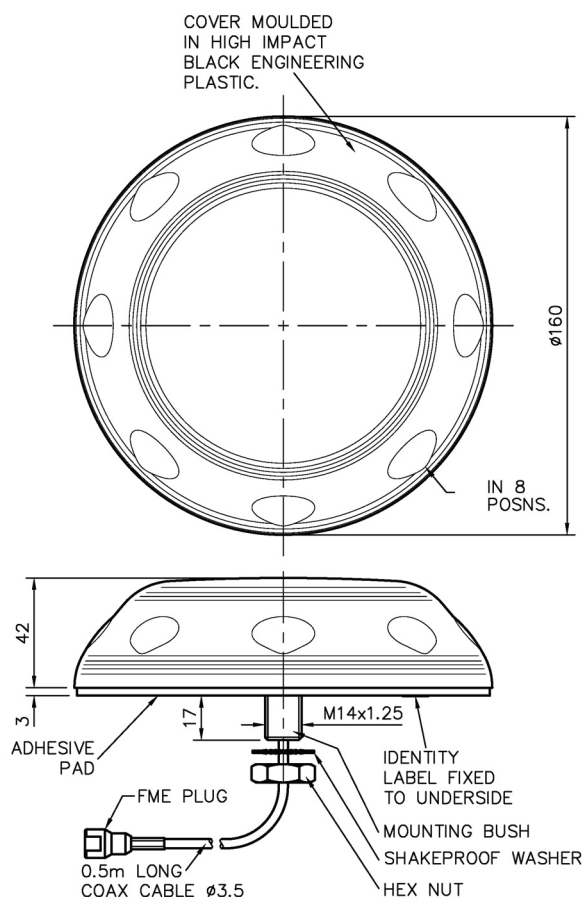

Typical E-Plane (390MHz)

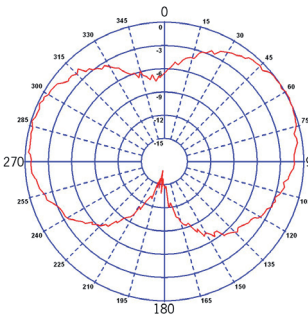

Typical H-Plane (390MHz)

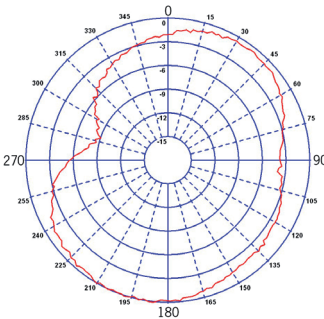

Typical VSWR*

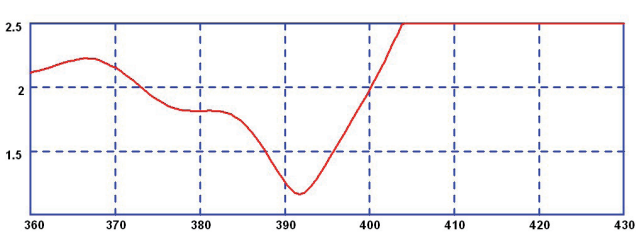

*measured in free space without cable

Part No.	
LP390	
Electrical Data	
Frequency Range (MHz)	380-400
Operational Band	S1
Peak Gain: Isotropic	0dBi
Compared to ¼ wave	-2dB
Bandwidth @ 2:1 VSWR	5%
Polarisation	Vertical
Pattern	Omni-directional
Impedance	50Ω
Max Input Power (W)	20
Mechanical Data	
Dimensions (mm)	Height 42 (1.65")
	Diameter 160 (6.29")
Operating Temp (°C)	-40°/+80°C (-40°/+176°F)
Material	ASA
Colour	Black
Ingress Protection	IP65 (certificate no. 6267/2)
Mounting Data	
Fixing	Panel mount
Mounting hole size (mm)	14 (0.5")
Cable Data	
Type	C35
Thickness (mm)	3.5 (0.13")
Length (m)	0.5 (1' 7")
Termination	FME Plug

distributed by **swisspoint**
akkus & batterien • zubehör

Swiss Point AG | Moospark 10 | 6221 Rickenbach
Tel. +41 62 721 82 82 | info@swiss-point.ch
www.swiss-point.ch



Panorama Antennas Ltd
Frogmore, London, SW18 1HF, United Kingdom

T: +44 (0)20 8877 4444
F: +44 (0)20 8877 4477
E: sales@panorama-antennas.com
www.panorama-antennas.com

Waiver: The data given above is indicative of the performance of the product/s under particular conditions and does not imply a guarantee of performance. These specifications are subject to change without notice.
Copyright © Panorama Antennas Ltd. All rights reserved.